

Lower Level

(Access to WildWoods and Fernbank Forest)



Entry Level

(Access to Parking Lot/Street Level)

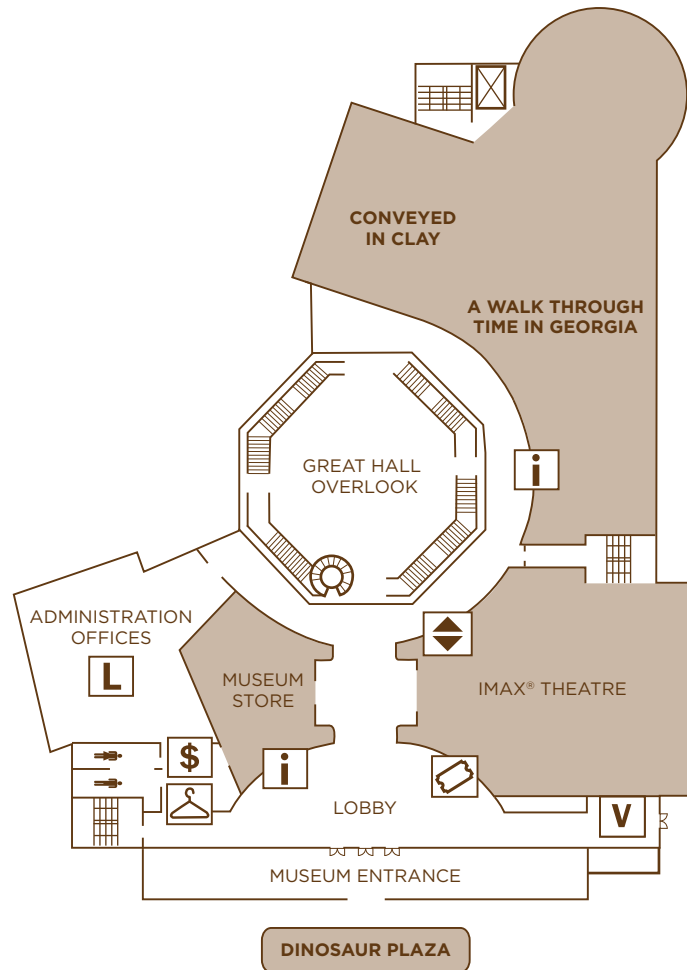

Upper Level

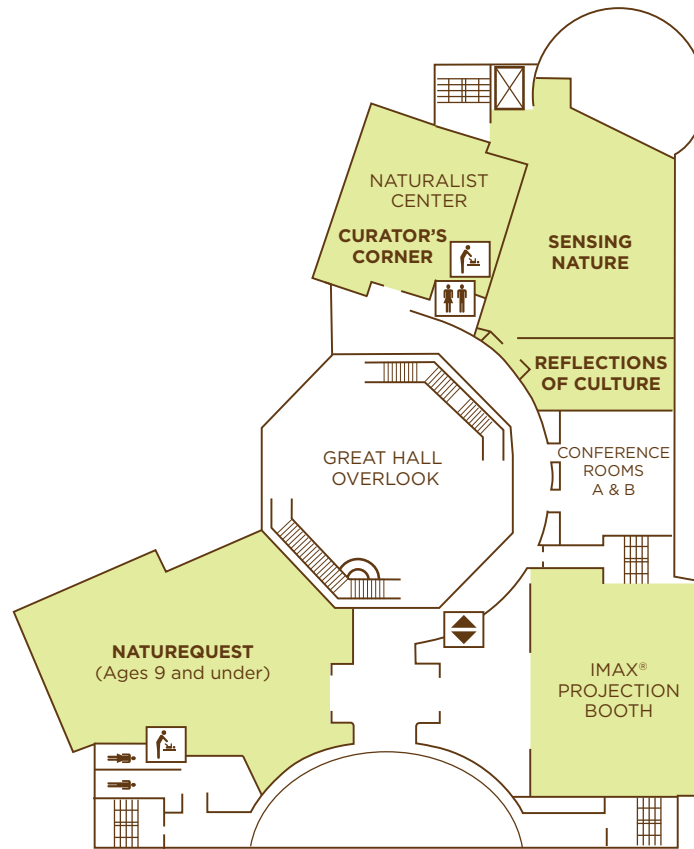

- ATM
- Coat Check
- Elevator
- Information
- Lost and Found
- Nursing Station
- Restrooms
- Ticketing
- Vending

Our Mission

Fernbank Museum is a 501(c)3 not-for-profit organization that inspires life-long learning of natural history through immersive programming and unmatched experiences to encourage a greater appreciation of our planet and its inhabitants.

Membership

Convert a portion of today's tickets into a membership and take immediate advantage of membership benefits.* Visit the Box Office for details.

Visitor Information

- Museum Store hours: Monday – Saturday, 10am - 5pm; Sunday 12pm – 5pm
- Fernbank Café hours: Monday – Saturday, 11am - 3pm; Sunday 12pm – 3pm
- For safety and comfort of all visitors, Fernbank does not allow skateboards, roller skates or use of Heelys®.
- Fernbank is a nicotine-free campus. Smoking, including e-cigarettes, is not allowed on the Museum campus.
- All experiences inside the Museum and within WildWoods are ADA accessible. However, due to the natural terrain of Fernbank Forest, some areas include steep inclines, rugged features and unpaved trails.
- Share your memories with us on social media: @FernbankMuseum or #FernbankMuseum

We hope you enjoy your visit! If you have questions or need assistance, simply ask a volunteer or staff member.

We also invite you to enjoy Deepdene Park and Dellwood Park, which are free woodland areas on Fernbank's campus along Ponce de Leon Avenue.

* Valid on same-day purchases only.

Free Wi-Fi (Use "attwifi" option.)



767 Clifton Road, NE Atlanta, GA 30307 404.929.6300
 FernbankMuseum.org © 2016 Fernbank Museum of Natural History



Visitor Map

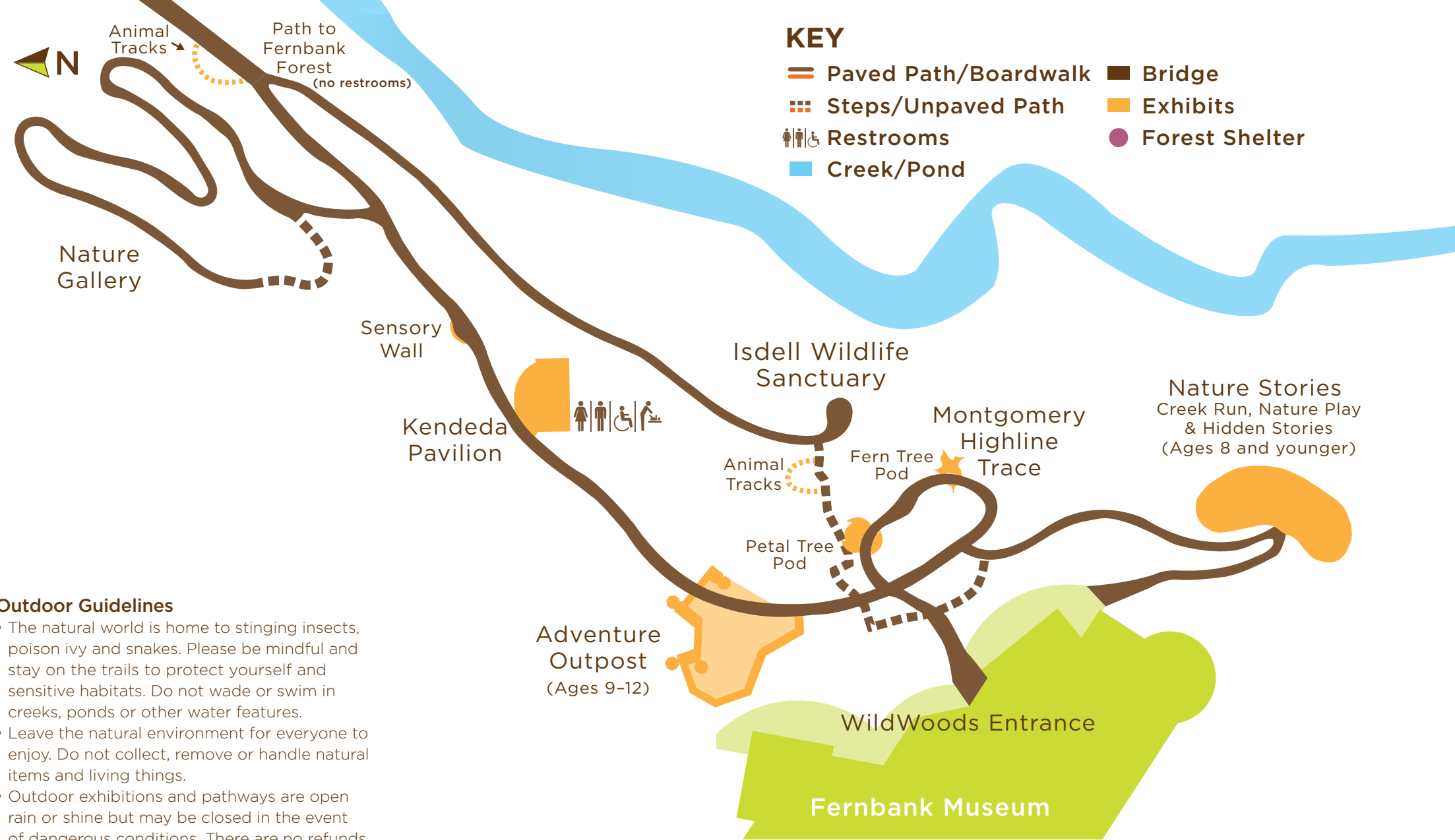

- Outdoor Guidelines**
- The natural world is home to stinging insects, poison ivy and snakes. Please be mindful and stay on the trails to protect yourself and sensitive habitats. Do not wade or swim in creeks, ponds or other water features.
 - Leave the natural environment for everyone to enjoy. Do not collect, remove or handle natural items and living things.
 - Outdoor exhibitions and pathways are open rain or shine but may be closed in the event of dangerous conditions. There are no refunds due to weather conditions.
 - Food and drinks, other than water, are not permitted in Fernbank Forest or WildWoods.



- Outdoor Guidelines cont'd**
- There are no restrooms, water or trash facilities in Fernbank Forest. Restrooms and water fountains are available inside the Museum and in WildWoods at the Kendeda Pavilion.
 - Fernbank Forest closes at 4:30pm, and the Museum closes at 5pm. For those with timed programs, including IMAX® tickets, please be aware that it takes a minimum of 10-15 minutes to walk from the Fernbank Forest gate to the Museum.